

# 290 Drop-Pintle Coupling

## ORDERING INFORMATION

### Coupling:

- 290

### Optional Accessories:

- Bolt Kit 507: Four - 3/4 in. (19 mm) O.D. x 2 3/4 in. (70 mm) long bolts and locknuts.
- Latch Gage 14026 (page 66): To determine latch gap limit.



\*Hook Only

## SPECIFICATIONS

<b>Maximum Gross Trailer Weight:</b>	70,000 lbs.	(31,751 kg)
<b>Maximum Tongue Weight:</b>	14,000 lbs.	(6,350 kg)
<b>Upward Vertical Capacity:</b>	40,000 lbs.	(18,143 kg)
<b>Maximum Eye X-Section:</b>	1 13/16 in.	(46 mm)
<b>Minimum Eye Opening:</b>	2 3/8 in.	(60 mm)
<b>Unit Weight:</b>	48.5 lbs.	(22.0 kg)

If overhead clearance is an issue, the 290 or one of Premier's many other Drop-Pintle style couplings may be the solution. Our 290 features a tough wear resistant Premalloy hook and internal strike-resistant latching system.

## DRAWING DETAIL

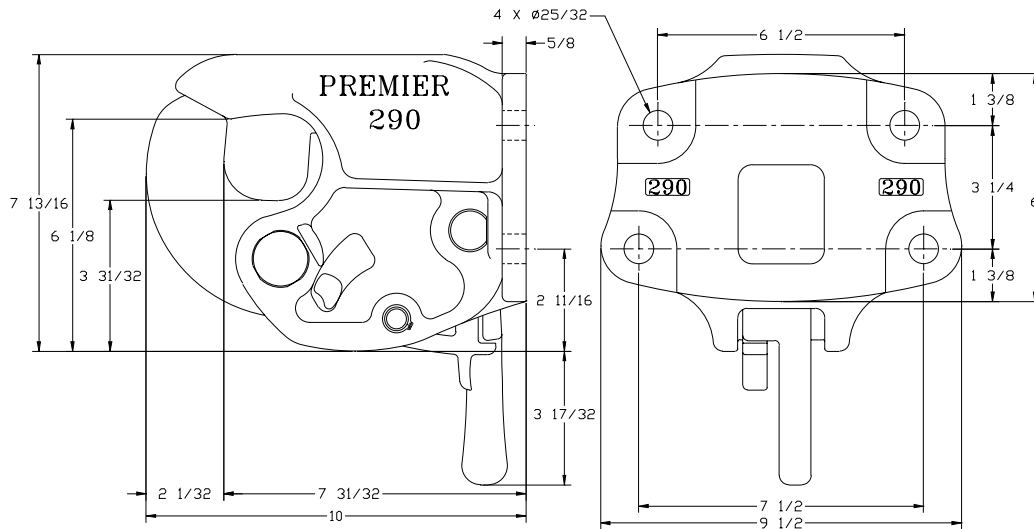

## REPLACEMENT PART INFORMATION

### 290RK Parts Kit Includes:

- |                      |              |
|----------------------|--------------|
| 44-62: Snap Ring (2) | 298: Pin     |
| 291: Handle          | 299: Spacer  |
| 292: Hook            | 299A: Spring |
| 293: Lever           |              |
| 294: Bolt            |              |
| 295Z: Pin            |              |
| 295Z-87: Snap Ring   |              |
| 296: Spring          |              |
| 297: Locknut         |              |

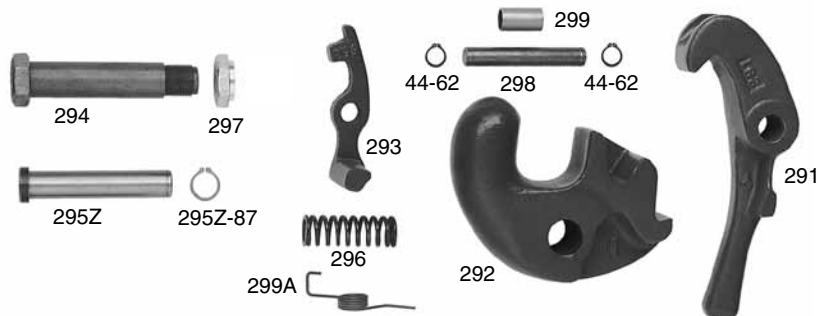

## IMPORTANT GUIDELINES that apply to all Premier Non-Air Couplings

- Do not weld on any coupling assembly
- Always use Grade-8 fasteners properly torqued
- Do not apply lubricants to the coupling hook
- Clean & inspect coupling for damage & excessive wear prior to each and every use
- Lubricate all coupling components at a minimum of 90 day intervals
- Do not bind-up (Jackknife) any application as stresses can cause damage to products or components, resulting in failure and detachment of the trailer while in use

