

# 235NT Swivel Coupling

## ORDERING INFORMATION

### Coupling:

- 235NT

### Optional Accessories:

- Wear Gage 14011 (page 75): To determine hook wear limits
- Latch Gage 14026 (page 75): To determine latch gap limit.

## SPECIFICATIONS

<b>Maximum Gross Trailer Weight:</b>	60,000 lbs.	(27,215 kg)
<b>Maximum Tongue Weight:</b>	12,000 lbs.	(5,443 kg)
<b>Ultimate Latch Capacity:</b>	20,000 lbs.	(9,071 kg)
<b>Maximum Eye X-Section:</b>	1 11/16 in.	(43 mm)
<b>Minimum Eye Opening:</b>	2 1/8 in.	(54 mm)
<b>Unit Weight:</b>	32 lbs.	(14.5 kg)

Premier's 235NT Swivel is a bit heavier duty than our 135NT Swivel for those extra tough jobs. When rough uneven ground is a problem, the 235NT Swivel may be the answer. (**NOT** to be used with swivel-type drawbar eye.)

## DRAWING DETAIL

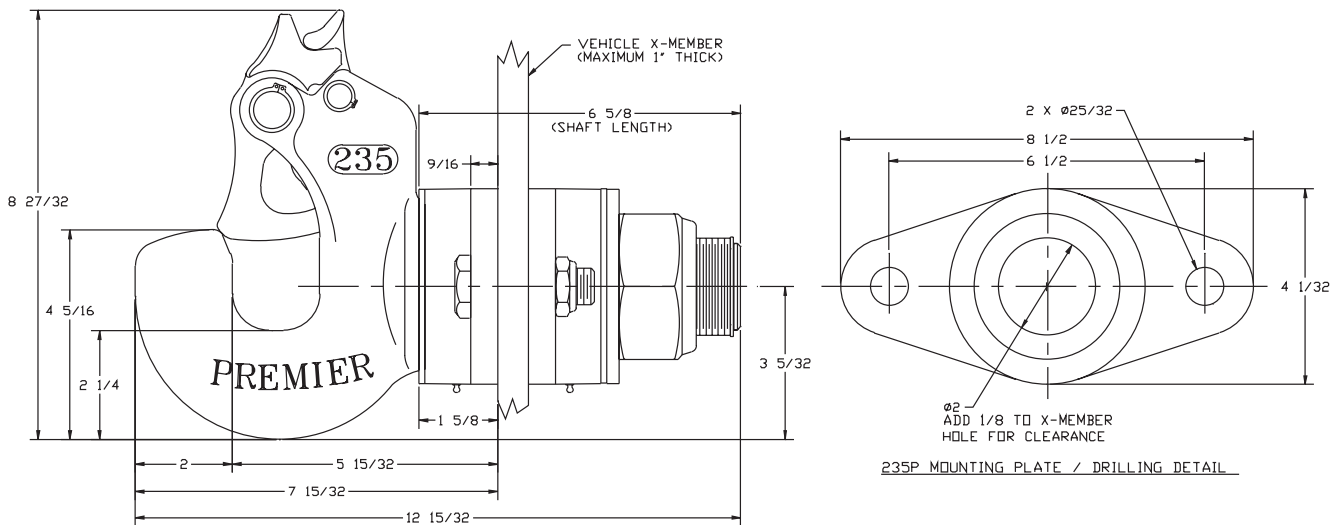

## REPLACEMENT PART INFORMATION

### Model 235NT Parts Available:

131: Pin	144-75: Snap Ring (2)
132: Latch	275-50: Snap Ring (2)
132B: Bushing	235P: Mounting Plate (2)
132A: Spring	238: Washer
133: Latch Lock	208: Snap Ring
135A: Spring	416: Locknut
134: Pin	
237NT: Nylatron	
134B: Bushing (2)	
Bushing	

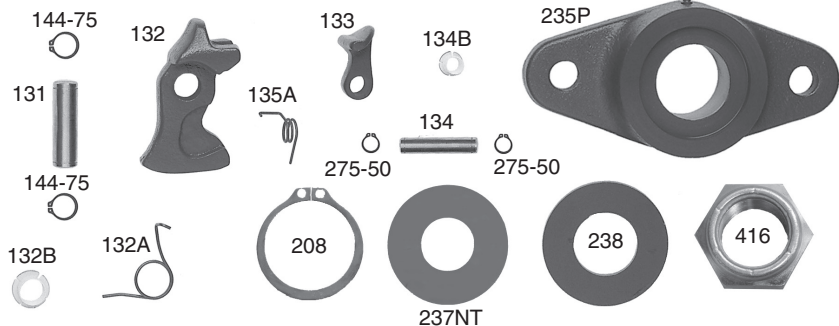

### IMPORTANT GUIDELINES that apply to all Premier Non-Air Couplings

- Do not weld on any coupling assembly
- Always use Grade-8 fasteners properly torqued
- Do not apply lubricants to the coupling hook
- Clean & inspect coupling for damage & excessive wear prior to each and every use
- Lubricate all coupling components at a minimum of 90 day intervals
- Do not bind-up (Jackknife) any application as stresses can cause damage to products or components, resulting in failure and detachment of the trailer while in use

