

690L / 690R / 690T Drop-Pintle Coupling



*Hook Only



690L

690T

Premier's 690 and 690T couplings offer similar features to our model 590 (page 37) but with higher load capacities. The 690T has a different style latch handle which makes opening of the horn easier when side clearance is an issue. Both have horns made of Premier's exclusive Premalloy for maximum wear resistance.

ORDERING INFORMATION

Coupling:

- 690L / 690R / 690T

Optional Accessories:

- Bolt Kit 507: Four - 3/4 in. (19 mm) O.D. x 2 3/4 in. (70 mm) long bolts and locknuts
- Wear Gage 14014 (page 66): To determine hook wear limits.
- Latch Gage 14026 (page 66): To determine latch gap limit.

SPECIFICATIONS

Maximum Gross Trailer Weight:	90,000 lbs.	(40,823 kg)
Maximum Tongue Weight:	18,000 lbs.	(8,164 kg)
Upward Vertical Capacity:	40,000 lbs.	(18,143 kg)
Maximum Eye X-Section:	1 11/16 in.	(43 mm)
Minimum Eye Opening:	2 3/8 in.	(60 mm)
Unit Weight:	45 lbs.	(20.4 kg)

DRAWING DETAIL

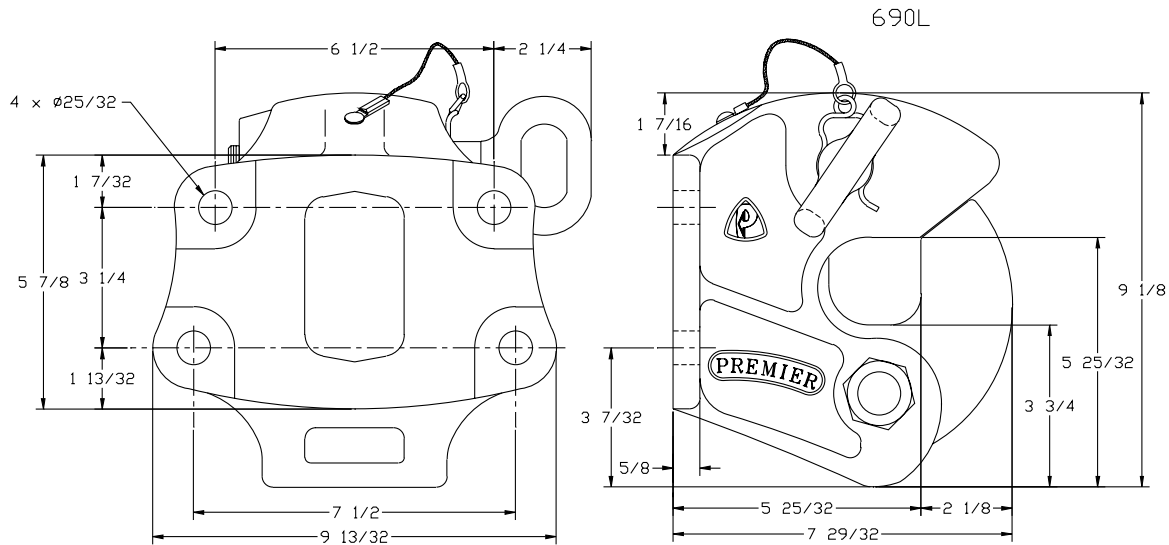

REPLACEMENT PART INFORMATION



(Also available: 691R and 691TW Handle Assemblies.)

690LRK/690RRK/690TRK Parts Kit Includes:

- | | |
|----------------------------------------|------------------------------------|
| 16DS: Drive Screw | **691W: Handle Lug & Shaft |
| 266: Spring | 692: Hook |
| 294: Bolt | *693: Pawl (specify left or right) |
| 297: Locknut | 695: Spring |
| 387: Locknut | **695T: Spring |
| 581EF: Clip & Cable | |
| 691: Handle | |
| *691C: Bushing (specify left or right) | |
| *691L: Handle Assembly | |
| **691T: Handle | |
- *Available individually. **Parts for 690T only

IMPORTANT GUIDELINES that apply to all Premier Non-Air Couplings

- Do not weld on any coupling assembly
- Always use Grade-8 fasteners properly torqued
- Do not apply lubricants to the coupling hook
- Clean & inspect coupling for damage & excessive wear prior to each and every use
- Lubricate all coupling components at a minimum of 90 day intervals
- Do not bind-up (Jackknife) any application as stresses can cause damage to products or components, resulting in failure and detachment of the trailer while in use

