

790 Drop-Pintle Coupling

ORDERING INFORMATION

Coupling:

- 790

Optional Accessories:

- Latch Gage 14026 (page 66): To determine latch gap limit.



SPECIFICATIONS

Maximum Gross Trailer Weight:	150,000 lbs.	(68,038 kg)
Maximum Tongue Weight:	30,000 lbs.	(13,607 kg)
Upward Vertical Capacity:	40,000 lbs.	(18,143 kg)
Maximum Eye X-Section:	1 13/16 in.	(46 mm)
Minimum Eye Opening:	3 in.	(76 mm)
Unit Weight:	82 lbs.	(37.2 kg)

The brute of drop-down style couplings, Premier's 790 has exceptional strength and was designed for those tough demanding applications where extra toughness is required. As with all our drop-down style couplings, latching is automatic.

DRAWING DETAIL

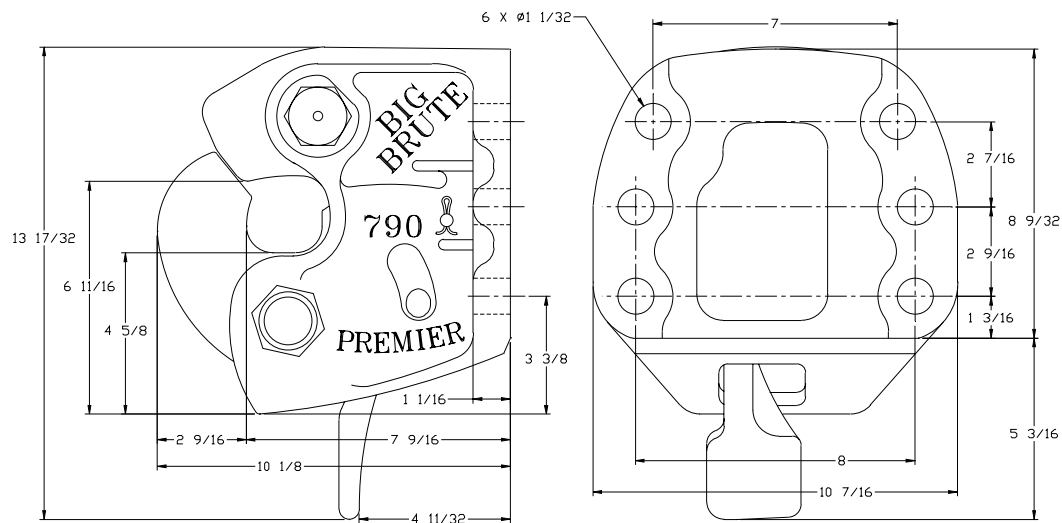

REPLACEMENT PART INFORMATION

790RK Parts Kit Includes:

- 791: Handle & Pawl
- 792: Hook
- 793: Lever
- 793B: Spring
- 793B-1: Pin
- 794Z: Bolt
- 795Z: Bolt
- 796: Spring
- 797: Locknut
- 798: Locknut
- 793CP: Cotter Pin

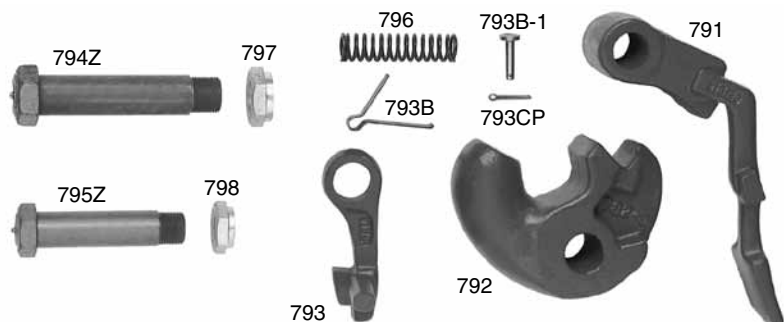

IMPORTANT GUIDELINES that apply to all Premier Non-Air Couplings

- Do not weld on any coupling assembly
- Always use Grade-8 fasteners properly torqued
- Do not apply lubricants to the coupling hook
- Clean & inspect coupling for damage & excessive wear prior to each and every use
- Lubricate all coupling components at a minimum of 90 day intervals
- Do not bind-up (Jackknife) any application as stresses can cause damage to products or components, resulting in failure and detachment of the trailer while in use