

# 480 Coupling



One of our highest capacity non-air couplings, the model 480 has high strength latch components that are strike-resistant and concealed within the coupling body. Conveniently located grease zerks provide for easy maintenance of internal components.

## ORDERING INFORMATION

### Coupling:

- 480

### Optional Accessories:

- Bolt Kit 507: Four - 3/4 in. (19 mm) O.D. x 2 3/4 in. (70 mm) long bolts and locknuts.
- Wear Gage 14014 (page 75): To determine hook wear limits.
- Latch Gage 14026 (page 75): To determine latch gap limit.

## SPECIFICATIONS

<b>Maximum Gross Trailer Weight:</b>	130,000 lbs.	(58,966 kg)
<b>Maximum Tongue Weight:</b>	21,000 lbs.	(9,525 kg)
<b>Ultimate Latch Capacity:</b>	30,000 lbs.	(13,607 kg)
<b>Maximum Eye X-Section:</b>	1 13/16 in.	(46 mm)
<b>Minimum Eye Opening:</b>	2 3/8 in.	(60 mm)
<b>Unit Weight:</b>	34.5 lbs.	(15.6 kg)

## DRAWING DETAIL

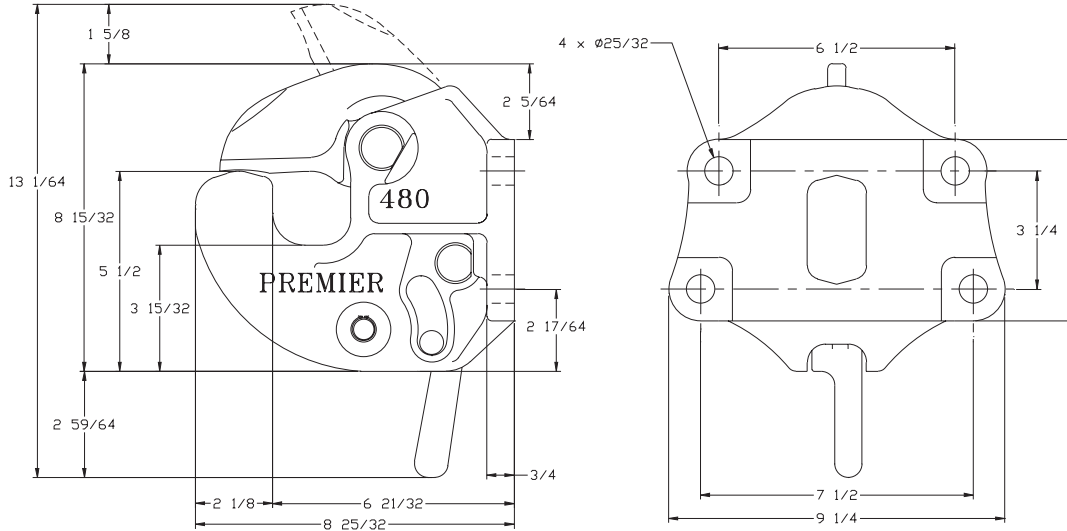

## REPLACEMENT PART INFORMATION

### 480RK Parts Kit Includes:

- |                      |             |
|----------------------|-------------|
| 44-62: Snap Ring (2) | 388: Pin    |
| 266: Spring          | 389: Spacer |
| 295Z-87: Snap Ring   | 482: Latch  |
| 381: Handle          |             |
| 382A: Spring         |             |
| 383: Lever           |             |
| 384Z: Bolt           |             |
| 385Z: Pin            |             |
| 387: Locknut         |             |

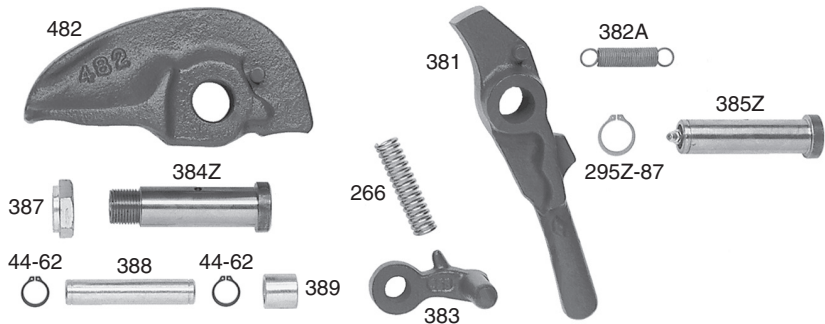

## IMPORTANT GUIDELINES that apply to all Premier Non-Air Couplings

- Do not weld on any coupling assembly
- Always use Grade-8 fasteners properly torqued
- Do not apply lubricants to the coupling hook
- Clean & inspect coupling for damage & excessive wear prior to each and every use
- Lubricate all coupling components at a minimum of 90 day intervals
- Do not bind-up (Jackknife) any application as stresses can cause damage to products or components, resulting in failure and detachment of the trailer while in use

